

36" Shelf
Surface Mounted

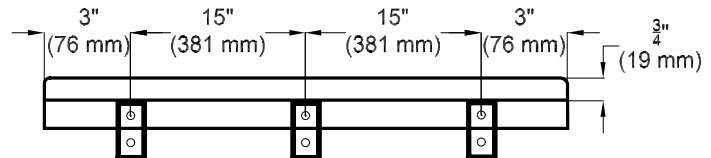

Front View

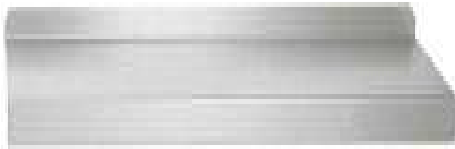
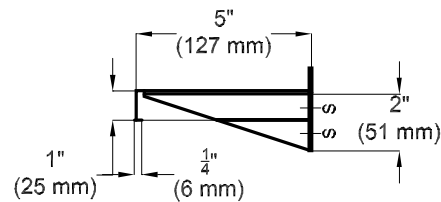

Side View

MATERIALS: Surface Mounted Shelf will be fabricated of alloy 18-8 stainless steel, type 304; brackets will be 18 gauge, shelf will be 18 gauge, with 1/2" lip on all four (4) sides.

OVERALL SIZE: 36" W x 5" D
(914 mm W x 127 mm D)

SPECIFICATIONS: Surface Mounted Shelf will be fabricated of alloy 18-8 stainless steel, type 304; brackets will be 18 gauge, shelf will be 18 gauge, with 1/2" lip on all four (4) sides. Front lip will be hemmed under for safety. All exposed surfaces will be No. 4 satin finish and will be protected during shipment with a PVC film that removes easily after installation. Structural assembly of shelf and bracket supports will be of welded construction.

INSTALLATION: Unit is surface mounted on wall or partition using No 10 self-tapping screws through holes provided in support brackets. Screws are not provided by manufacturer.



ADA Accessibility Guidelines: Unit is to be installed so that shelf top is between 48" maximum above finished floor and 32" minimum above finished floor; for most common utility, typical is 42" above finished floor or 18" above wash basin.